

REVISIONS:

REV.	REV. ISSUE
1	05/10/2022

[illegible]

2203

**GATEWAY LUXURY
APARTMENTS**

LOCATED AT:
950 N POWERLINE ROAD,
POMPANO BEACH FL 33069

BURGOS LANZA & ASSOCIATES
1248 S ALHAMBRA CIRCLE
CORAL GABLES, FL 33146
(786) 554-9035
AIA 38052598
WWW.BURGOSLANZA.COM
CARLOS LANZA ARCHITECT AR 0095925
CARLOS LANZA ARCHITECT AR 0010601
S. LANZA ARCHITECTS AND ARE
EXPRESS WRITTEN CONSENT OF THE SAME

BURBOS
LANZA
ARCHITECTS & PLANNERS
AA 26001519

Pablo
Burgos

Digitally signed by Pablo Burgos
DN: cn=Pablo Burgos, o=Burgos
Lanzan & Assoc., ou=AR95925,
email=pburgos@burgoslanza.co
m, c=US
Date: 2022.05.11 14:28:49 -04'00'

DATE	11/09/21
DRAWN	CR
PROJECT No.	2203
SCALE	AS-SHOWN

SITE COLUMNS

$1/2'' = 1'-0''$

22

DRC
PZ22-12000008
6/15/2022

NOTE:
REFER TO STRUCTURAL DRAWINGS
FOR GENERAL STRUCTURAL NOTES.
REFER TO CIVIL DRAWINGS FOR
ADDITIONAL SITE PLAN INFORMATION

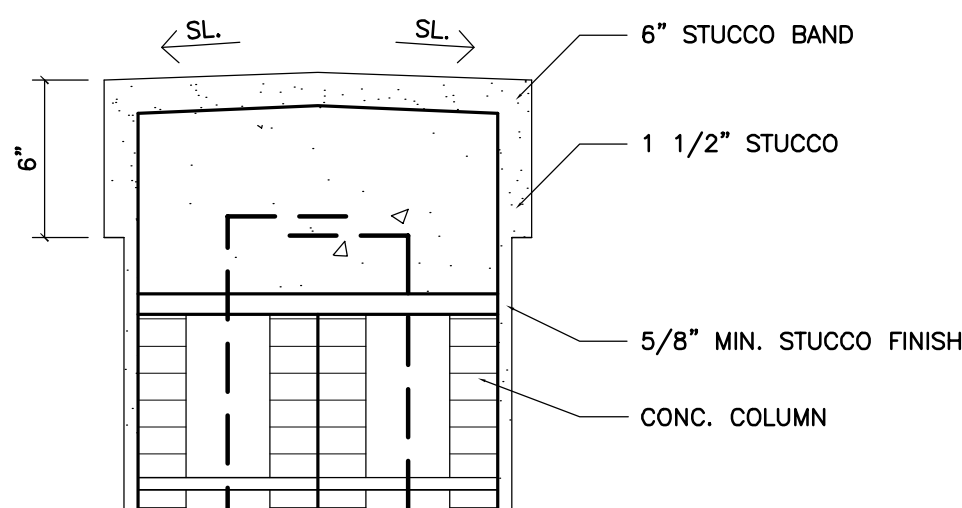
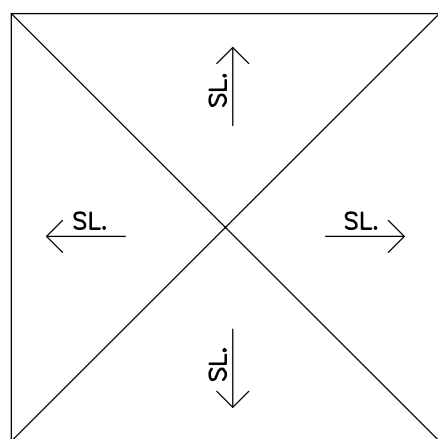

4 CONCRETE CAP DETAIL

SCALE: 1 1/2" = 1'-0"

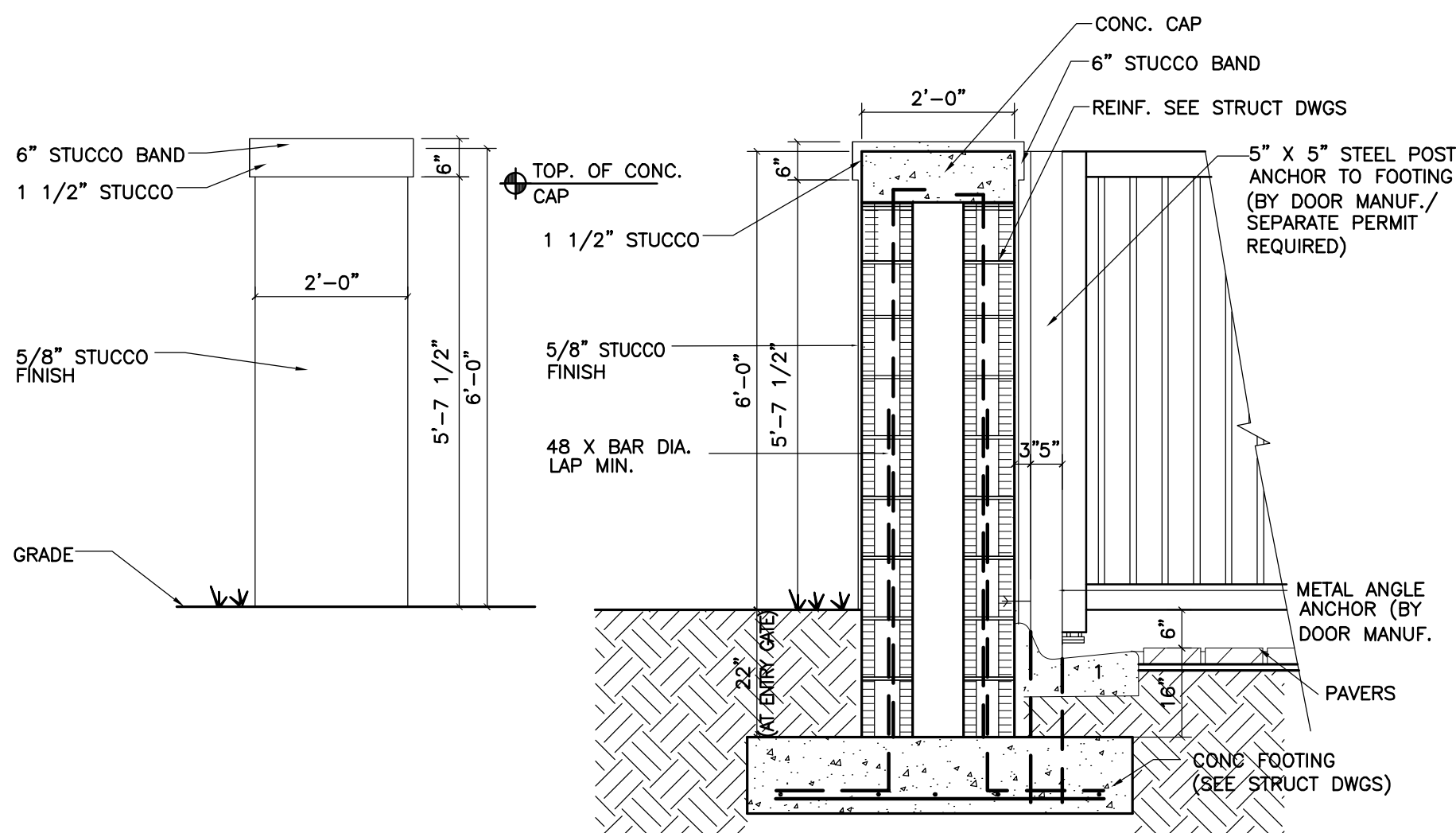
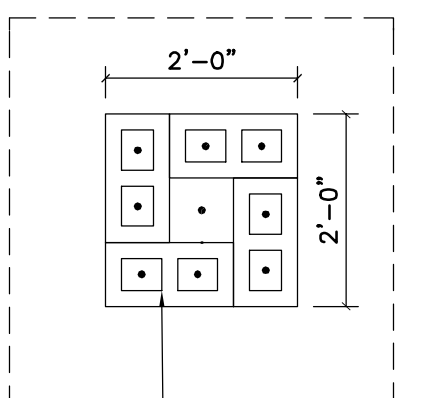

① COLUMN TYPE "A"
24" X 24" X 6'-0"(H)

24" X 24" X 6'-0"(H)

SCALE: 1/2" = 1'-0"